

The Crayo Muse Watch

(CR1901-CR1907)

Setting Instructions:

- 1) Pull the crown out two clicks then rotate until the current time is displayed.
- 2) Push the crown in one click and rotate clockwise to set the current date.¹
- 3) Push the crown in one click to commence timekeeping.

Band Resizing:

Maximum Wrist Size: 8 ¼ inches

Minimum Wrist Size: 6 inches

- For smaller wrists, ensure that the minimum fit diameter is suitable prior to resizing.²
- Remove only one link at a time.
- Test fit after each link removal to avoid over-trimming.
- Alternate link removal from one side of the band to the other if multiple links are to be removed.
- Fine adjustment is achieved via the three alternate spring bar mounting locations on the clasp.

Trimming Instructions:

- 1) Disconnect the portion of the band to be trimmed from the clasp by dislocating the spring bar.
- 2) Using a sharp blade cut straight down along the central cut indication line.
- 3) Reattach the band to the clasp in the reverse order of removal utilizing the new spring bar hole.

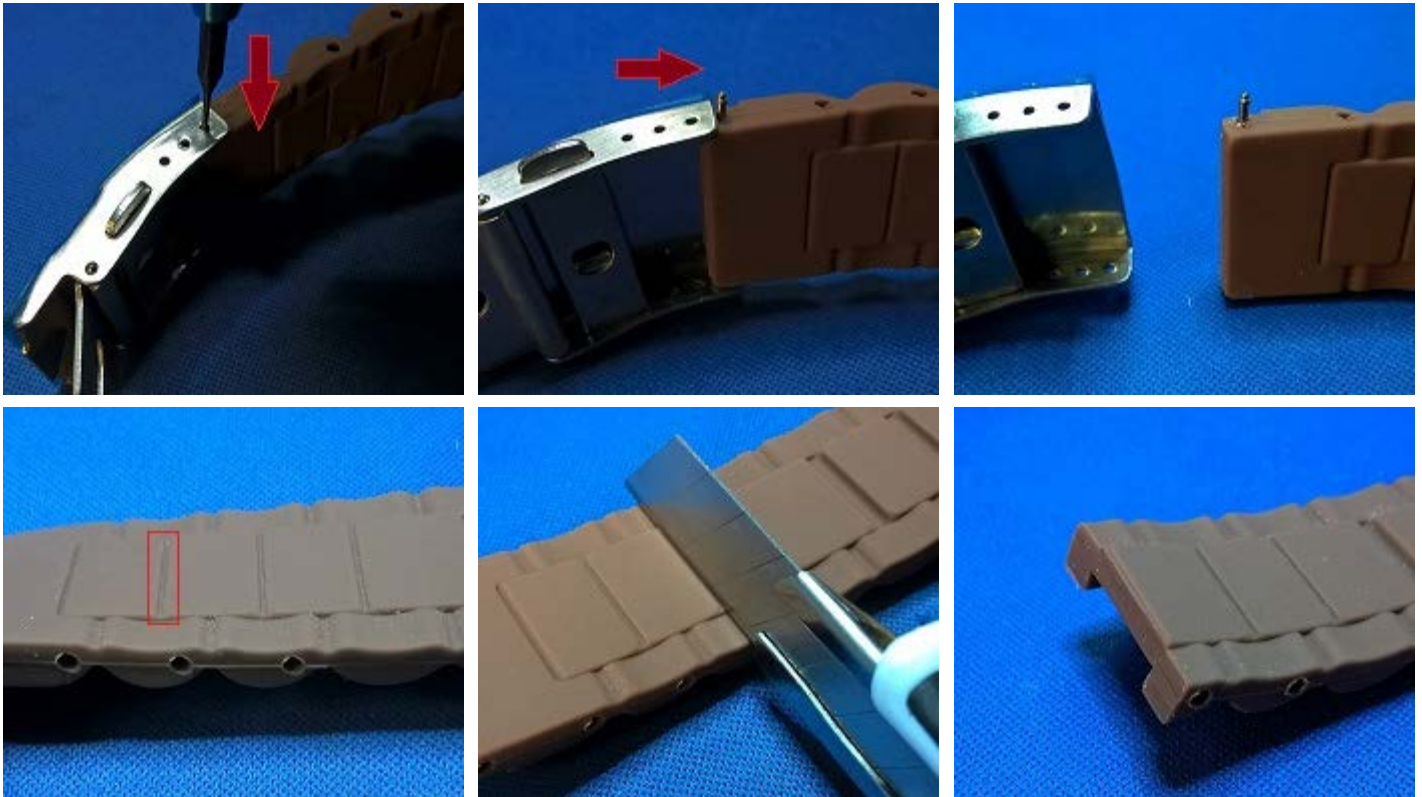

¹ If the date indicator is cycling in the afternoon rather than midnight, advance the time 12 hours then readjust the date indicator as necessary.

² Modification to the band will negate return / exchange eligibility.